

# Location:



## 6605-TRM, 6605TRMTC Shower/Hand Shower Trim Specification Submittal



### Feature Highlights

- Unity Shower/Hand Shower Trim
- Requires Temptrol® Pressure Balancing Tub/Shower Valve
- Requires Symmons Dual Outlet Diverter Valve
- Metal lever handle
- Cradle for hand shower wand
- Dual checks for backflow protection
- 60" flexible metal hose
- 1 mode hand shower wand with easy to clean nozzles
- 1 mode showerhead with easy to clean nozzles
- 2.0 gpm (7.6 L/min) flow restrictors
- Components shall be metal and nonmetallic construction, plated in standard Polished Chrome finish
- Available with TA-10 flow control spindle and T-12A cap assembly for Temptrol valve bodies installed with Test Cap (order p/n 6605TRMTC)
- For optional in-line vacuum breaker order p/n EF-109

### Options/Modifications

- ☐ **1.5** **CG** 1.5 gpm (5.7 L/min) flow restrictor
- ☐ **L1** Less showerhead
- ☐ **L2** Less hand shower (wand only)
- ☐ **L3** Less showerhead & hand shower wand
- ☐ **L4** Less head, arm and flange
- ☐ **L5** Less hand shower system (less cradle, hose, wand & elbow)
- ☐ **L7** Less handle
- ☐ **STN** Satin Nickel finish

**Note:** Append appropriate -suffix to model number.

### Model Numbers

- ☐ **6605-TRM**  
Shower/Hand Shower Trim,  
Temptrol Pressure Balancing Tub/Shower Valve and  
Symmons Dual Outlet Diverter valve ordered separately
- ☐ **6605TRMTC**  
Shower/Hand Shower Trim with TA-10 flow control spindle  
and T-12A cap assembly, must order Temptrol valve with  
Test Cap

### Warranty

**Limited Lifetime** - to the original end purchaser in consumer/residential installations.

**10 Years** - for commercial/industrial installations. Refer to [www.symmons.com/warranty](http://www.symmons.com/warranty) for complete warranty information.



### Compliance

- ASME A112.18.1/CSA B125.1
- WaterSense 1.5 gpm (5.7 L/min)  
2.0 gpm (7.6 L/min)



### Architectural/ Engineering Specification

Symmons \_\_\_\_\_ With Unity Shower/Hand Shower Trim, requires Temptrol® pressure balancing tub/shower valve, Requires Symmons Dual Outlet Diverter Valve, metal lever handle, Cradle for hand shower wand, Dual checks for backflow protection, 60" flexible metal hose, 1 mode hand shower wand with easy to clean nozzles, 1 mode showerhead with easy to clean nozzles, 2.0 gpm (7.6 L/min) flow restrictor, Tub spout and showerhead not included, components shall be metal and nonmetallic construction, plated in standard Polished Chrome finish, available with TA-10 flow control spindle and T-12A cap assembly for Temptrol valve bodies installed with Test Cap (order p/n 6605TRMTC), For optional in-line vacuum breaker order p/n EF-109. 10 Year commercial Warranty. ASME A112.18.1/CSA B125.1, WaterSense 1.5 gpm (5.7 L/min), 2.0 gpm (7.6 L/min) Complaint. Available options include "1.5 - 1.5 gpm (5.7 L/min) flow restrictor", "L1 - Less showerhead", "L2 - Less hand shower wand", "L3 - Less showerhead & hand shower wand", "L4 - Less head, arm and flange", "L5 - Less hand shower system", "L6 - Less tub spout", "L7 - Less handle", "STN - Satin nickel finish".

6605-TRM, 6605TRMTC

## Dimensions

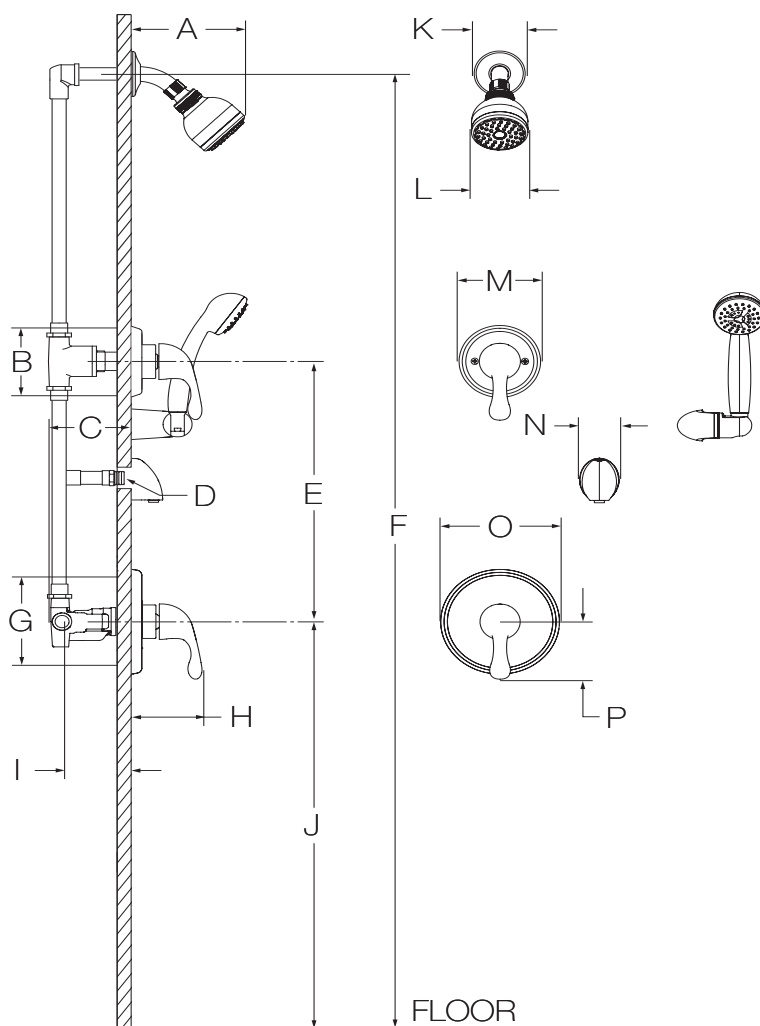

### Measurements

<b>A</b>	6-3/8", 162 mm
<b>B</b>	Diverter Valve Hole Size Min. Ø 3", 76 mm Max. Ø 3-1/4", 83 mm
<b>C</b>	3-1/2", 89 mm
<b>D</b>	Male 1/2" NPT fitting must be recessed 1/4" (6 mm) from finished wall
<b>E</b>	Ref. 10", 254 mm
<b>F</b>	Ref. 77", 1956 mm
<b>G</b>	Shower Valve Hole Size Min. Ø 3", 76 mm Max. Ø 4", 102 mm
<b>H</b>	3-3/4", 95 mm
<b>I</b>	Rough-in 2-3/8" ± 1/2", 60 mm ± 13 mm
<b>J</b>	Ref. 42", 1067 mm
<b>K</b>	Ø 2-1/2", 64 mm
<b>L</b>	Ø 2-3/4", 70 mm
<b>M</b>	Ø 4-1/4", 108 mm
<b>N</b>	2-1/8", 54 mm
<b>O</b>	Ø 6-3/8", 162 mm
<b>P</b>	3-1/2", 89 mm

### Notes:

- 1) Valve body and piping not included and shown as reference only.
- 2) Plaster shield (p/n T-176) for dry wall, plaster or other type walls 1/2" or greater.
- 3) All dimensions measured from nominal rough-in (see I as reference).
- 4) Dimensions subject to change without notice.